

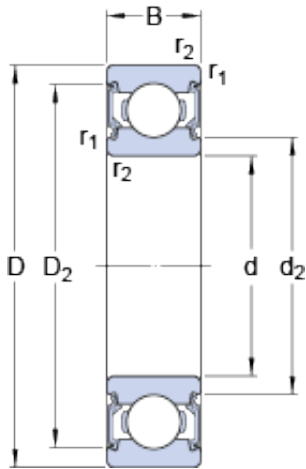

KRS Guide Wheel Bearing Co., Ltd



20 mm x 47 mm x 14 mm SKF
6204-2RSLTN9/HC5C3WT deep groove ball bearings

Bearing No. 6204-2RSLTN9/HC5C3WT

6204-2RSLTN9/HC5C3WT Bearing 2D drawings and 3D CAD models

Size	47x20x14 mm
Bore Diameter	47 mm
Outer Diameter	20 mm
Width	14 mm
d	20 mm
D	47 mm
B	14 mm
d ₂	26.3 mm
D ₂	40.6 mm
r _{1,2} - min.	1 mm
d _a - min.	25.6 mm
d _a - max.	26 mm
D _a - max.	41.4 mm
r _a - max.	1 mm
Basic dynamic load rating - C	13.5 kN
Basic static load rating - C ₀	6.6 kN
Fatigue load limit - P _u	0.28 kN
Reference speed	45000 r/min
Limiting speed	24000 r/min
Calculation factor - k _r	0.025
Calculation factor - f ₀	13
Category	Single Row Ball Bearings
Inventory	0.0



KRS Guide Wheel Bearing Co., Ltd

Manufacturer Name	SKF
Minimum Buy Quantity	N/A
Weight / Kilogram	0.101
Product Group	B00308
Enclosure	2 Seals
Precision Class	ABEC 1 ISO P0
Maximum Capacity / Filling Slot	No
Rolling Element	Ball Bearing
Snap Ring	No
Internal Special Features	Silicon Nitride Rolling Element Electrical Insulated
Cage Material	Polyamide
Enclosure Type	Contact Seal
Internal Clearance	C3-Loose
Inch - Metric	Metric
Long Description	20MM Bore; 47MM Outside Diameter; 14MM Outer Race Width; 2 Seals; Ball Bearing; ABEC 1 ISO P0; No Filling Slot; No Snap Ring; Silicon Nitride Rolling Element Electrical Insulated Internal Special
Other Features	Deep Groove Low Friction NBR Seal Hybrid Silicon Nitride Rolling Element WT Standard Grease
Category	Single Row Ball Bearing
UNSPSC	31171504
Harmonized Tariff Code	8482.10.50.68
Noun	Bearing
Keyword String	Ball
Manufacturer URL	http://www.skf.com
Manufacturer Item Number	6204-2RSLTN9/HC5C3W



KRS Guide Wheel Bearing Co., Ltd

	T
Weight / LBS	0.223
Bore	0.787 Inch 20 Millimeter
Outside Diameter	1.85 Inch 47 Millimeter
Outer Race Width	0.551 Inch 14 Millimeter
Inner Race Width	0 Inch 0 Millimeter
bore diameter:	20 mm
static load capacity:	6.55 kN
outside diameter:	47 mm
precision rating:	Not Rated
overall width:	14 mm
finish/coating:	Uncoated
bore type:	Round
cage material:	Fiberglass Reinforced Nylon
closure type:	Double Sealed
outer ring width:	14 mm
row type & fill slot:	Single Row Non-Fill Slot
fillet radius:	1 mm
internal clearance:	C3, C5
maximum rpm:	17000 RPM
operating temperature range:	-40 to +210 ° F
series:	62
dynamic load capacity:	13.5 kN
d_2	26.3 mm
D_2	40.6 mm
$r_{1,2}$ min.	1 mm
d_a min.	25.6 mm
d_a max.	26 mm
D_a max.	41.4 mm
r_a max.	1 mm
Basic dynamic load rating C	13.5 kN
Basic static load rating C_0	6.55 kN



KRS Guide Wheel Bearing Co., Ltd

Fatigue load limit P_u	0.28 kN
Calculation factor k_r	0.025
Calculation factor f_0	13.1
Mass bearing	0.097 kg