

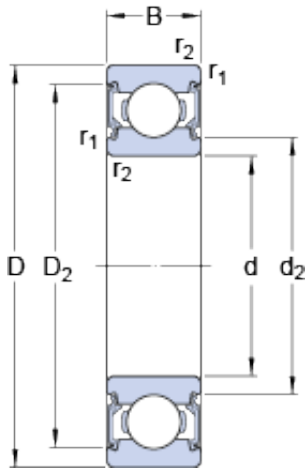

KRS Guide Wheel Bearing Co., Ltd



20 mm x 47 mm x 14 mm SKF 6204-2RSL deep groove ball bearings

Bearing No. 6204-2RSL

6204-2RSL Bearing 2D drawings and 3D CAD models

Size	47x20x14 mm
Bore Diameter	47 mm
Outer Diameter	20 mm
Width	14 mm
d	20 mm
D	47 mm
B	14 mm
d ₂	26.05 mm
D ₂	40.59 mm
r _{1,2} - min.	1 mm
d _a - min.	25.6 mm
d _a - max.	26 mm
D _a - max.	41.4 mm
r _a - max.	1 mm
Basic dynamic load rating - C	13.5 kN
Basic static load rating - C ₀	6.6 kN
Fatigue load limit - P _u	0.28 kN
Reference speed	32000 r/min
Limiting speed	17000 r/min
Calculation factor - k _r	0.025
Calculation factor - f ₀	13
Category	Single Row Ball Bearings
Inventory	0.0
Manufacturer Name	SKF



KRS Guide Wheel Bearing Co., Ltd

Minimum Buy Quantity	N/A
Weight / Kilogram	0.114
Product Group	B00308
Enclosure	2 Seals
Precision Class	ABEC 1 ISO P0
Maximum Capacity / Filling Slot	No
Rolling Element	Ball Bearing
Snap Ring	No
Internal Special Features	No
Cage Material	Steel
Enclosure Type	Contact Seal
Internal Clearance	C0-Medium
Inch - Metric	Metric
Long Description	20MM Bore; 47MM Outside Diameter; 14MM Outer Race Width; 2 Seals; Ball Bearing; ABEC 1 ISO P0; No Filling Slot; No Snap Ring; No Internal Special Features; C0-Medium Internal Clearance; Steel Cage;
Other Features	Deep Groove Low Friction NBR Seal
Category	Single Row Ball Bearing
UNSPSC	31171504
Harmonized Tariff Code	8482.10.50.68
Noun	Bearing
Keyword String	Ball
Manufacturer URL	http://www.skf.com
Manufacturer Item Number	6204-2RSL
Weight / LBS	0.234
Outside Diameter	1.85 Inch 47 Millimeter
Outer Race Width	0.551 Inch 14 Millimeter



KRS Guide Wheel Bearing Co., Ltd

Inner Race Width	0 Inch 0 Millimeter
Bore	0.787 Inch 20 Millimeter
bore diameter:	20 mm
static load capacity:	6.55 kN
outside diameter:	47 mm
finish/coating:	Uncoated
overall width:	14 mm
bearing material:	Steel
bore type:	Round
cage material:	Steel
closure type:	Double Sealed
fillet radius:	1 mm
row type & fill slot:	Single Row Non-Fill Slot
maximum rpm:	32000 rpm
snap ring included:	Without Snap Ring
weight:	0.23 lb
operating temperature range:	-40 to 212 ° F ° F
manufacturer product page:	Click here
dynamic load capacity:	13.5 kN
manufacturer upc number:	7316571823928
d_2	25.46 mm
D_2	40.59 mm
$r_{1,2}$ min.	1 mm
d_a min.	25.6 mm
d_a max.	26 mm
D_a max.	41.4 mm
r_a max.	1 mm
Basic dynamic load rating C	13.5 kN
Basic static load rating C_0	6.55 kN
Fatigue load limit P_u	0.28 kN
Calculation factor k_r	0.025
Calculation factor f_0	13



KRS Guide Wheel Bearing Co., Ltd

Mass bearing	0.11 kg
--------------	---------