

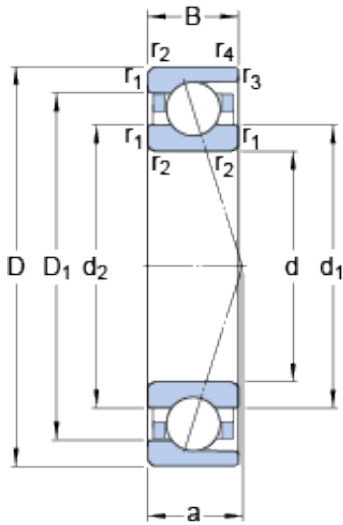

KRS Guide Wheel Bearing Co., Ltd



7204 ACD/P4A Bearing 2D drawings and 3D CAD models

20 mm x 47 mm x 14 mm SKF 7204 ACD/P4A angular contact ball bearings

Bearing No. 7204 ACD/P4A

Size	47x20x14 mm
Bore Diameter	47 mm
Outer Diameter	20 mm
Width	14 mm
d	20 mm
D	47 mm
B	14 mm
d ₁	29.1 mm
d ₂	29.1 mm
D ₁	38.7 mm
r _{1,2} - min.	1 mm
r _{3,4} - min.	0.3 mm
a	15 mm
d _a - min.	25.6 mm
d _b - min.	25.6 mm
D _a - max.	41.4 mm
D _b - max.	44.6 mm
r _a - max.	1 mm
r _b - max.	0.3 mm
d _n	31.1 mm
Basic dynamic load rating - C	11.4 kN
Basic static load rating - C ₀	5.6 kN
Fatigue load limit - P _u	0.236 kN
Limiting speed for grease	32000 r/min



KRS Guide Wheel Bearing Co., Ltd

Lubrication	
Limiting speed for oil lubrication	48000 mm/min
Ball - D_w	7.938 mm
Ball - z	11
G_{ref}	1.539 cm ³
Calculation factor - e	0.68
Calculation factor - Y_2	0.87
Calculation factor - Y_0	0.38
Calculation factor - X_2	0.41
Calculation factor - Y_1	0.92
Calculation factor - Y_2	1.41
Calculation factor - Y_0	0.76
Calculation factor - X_2	0.67
Preload class A - G_A	70 N
Preload class B - G_B	140 N
Preload class C - G_C	280 N
Preload class D - G_D	560 N
Calculation factor - f	1.03
Calculation factor - f_1	0.99
Calculation factor - f_{2A}	1
Calculation factor - f_{2B}	1.01
Calculation factor - f_{2C}	1.02
Calculation factor - f_{2D}	1.05
Calculation factor - f_{HC}	1
Preload class A	61 N/micron
Preload class B	79 N/micron
Preload class C	102 N/micron
Preload class D	135 N/micron



KRS Guide Wheel Bearing Co., Ltd

Category	Precision Ball Bearings
Inventory	0.0
Manufacturer Name	SKF
Minimum Buy Quantity	N/A
Weight / Kilogram	0
EAN	7316570490947
Product Group	B04270
Enclosure	Open
Precision Class	ABEC 7 ISO P4
Material - Ball	Steel
Number of Bearings	1 (Single)
Contact Angle	25 Degree
Preload	None
Raceway Style	1 Rib Outer Ring
Cage Material	Phenolic
Rolling Element	Ball Bearing
Flush Ground	No
Inch - Metric	Metric
Other Features	Single Row Angular Contact Super Precision High Capacity Basic Design
Long Description	20MM Bore; 47MM Outside Diameter; 14MM Width; Open Enclosure; ABEC 7 ISO P4 Precision; Steel Ball Material; 1 (Single) Bearing; 25 Degree Contact Angle; Phenolic Cage Material; 1 Rib Outer Ring Race
Category	Precision Ball Bearings
UNSPSC	31171531
Harmonized Tariff Code	8482.10.50.28
Noun	Bearing
Keyword String	Ball Angular Contact



KRS Guide Wheel Bearing Co., Ltd

Manufacturer URL	http://www.skf.com
Manufacturer Item Number	7204 ACD/P4A
Weight / LBS	0.238
Bore	0.787 Inch 20 Millimeter
Outside Diameter	1.85 Inch 47 Millimeter
Width	0.551 Inch 14 Millimeter
d_1	29.1 mm
d_2	29.1 mm
D_1	38.7 mm
$r_{1,2}$ min.	1 mm
$r_{3,4}$ min.	0.3 mm
d_a min.	25.6 mm
d_b min.	25.6 mm
D_a max.	41.4 mm
D_b max.	44.6 mm
r_a max.	1 mm
r_b max.	0.3 mm
d_n	31.1 mm
Basic dynamic load rating C	11.4 kN
Basic static load rating C_0	5.6 kN
Fatigue load limit P_u	0.236 kN
Attainable speed for grease lubrication	32000 r/min
Attainable speed for oil-air lubrication	48000 r/min
Ball diameter D_w	7.938 mm
Number of balls z	11
Reference grease quantity G_{ref}	1.539 cm ³
Preload class A G_A	70 N
Static axial stiffness, preload class A	61 N/ μ m
Preload class B G_B	140 N



KRS Guide Wheel Bearing Co., Ltd

Static axial stiffness, preload class B	79 N/ μ m
Preload class C G_C	280 N
Static axial stiffness, preload class C	102 N/ μ m
Preload class D G_D	560 N
Static axial stiffness, preload class D	135 N/ μ m
Calculation factor f	1.03
Calculation factor f_1	0.99
Calculation factor f_{2A}	1
Calculation factor f_{2B}	1.01
Calculation factor f_{2C}	1.02
Calculation factor f_{2D}	1.05
Calculation factor f_{HC}	1
Calculation factor e	0.68
Calculation factor (single, tandem) Y_2	0.87
Calculation factor (single, tandem) Y_0	0.38
Calculation factor (single, tandem) X_2	0.41
Calculation factor (back-to-back, face-to-face) Y_1	0.92
Calculation factor (back-to-back, face-to-face) Y_2	1.41
Calculation factor (back-to-back, face-to-face) Y_0	0.76
Calculation factor (back-to-back, face-to-face) X_2	0.67
Mass bearing	0.1 kg