

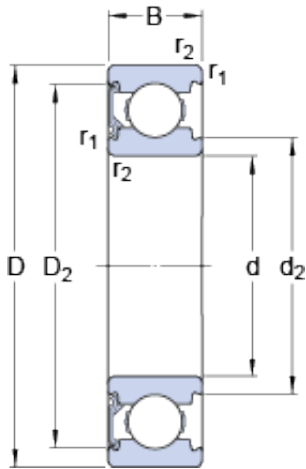

# KRS Guide Wheel Bearing Co., Ltd



20 mm x 47 mm x 14 mm SKF 6204-RSH deep groove ball bearings

Bearing No. 6204-RSH

6204-RSH Bearing 2D drawings and 3D CAD models

Size	47x20x14 mm
Bore Diameter	47 mm
Outer Diameter	20 mm
Width	14 mm
d	20 mm
D	47 mm
B	14 mm
d <sub>2</sub>	26.05 mm
D <sub>2</sub>	40.59 mm
r <sub>1,2</sub> - min.	1 mm
d <sub>a</sub> - min.	25.6 mm
d <sub>a</sub> - max.	26 mm
D <sub>a</sub> - max.	41.4 mm
r <sub>a</sub> - max.	1 mm
Basic dynamic load rating - C	13.5 kN
Basic static load rating - C <sub>0</sub>	6.6 kN
Fatigue load limit - P <sub>u</sub>	0.28 kN
Limiting speed	10000 r/min
Calculation factor - k <sub>r</sub>	0.025
Calculation factor - f <sub>0</sub>	13
Category	Single Row Ball Bearings
Inventory	0.0
Manufacturer Name	SKF
Minimum Buy Quantity	N/A



## KRS Guide Wheel Bearing Co., Ltd

Weight / Kilogram	0.104
EAN	7316571819211
Product Group	B00308
Enclosure	1 Seal
Precision Class	ABEC 1   ISO P0
Maximum Capacity / Filling Slot	No
Rolling Element	Ball Bearing
Snap Ring	No
Internal Special Features	No
Cage Material	Steel
Enclosure Type	Contact Seal
Internal Clearance	C0-Medium
Inch - Metric	Metric
Long Description	20MM Bore; 47MM Outside Diameter; 14MM Outer Race Width; 1 Seal; Ball Bearing; ABEC 1   ISO P0; No Filling Slot; No Snap Ring; No Internal Special Features; C0-Medium Internal Clearance; Steel Cage; C
Other Features	Deep Groove   NBR Seal
Category	Single Row Ball Bearing
UNSPSC	31171504
Harmonized Tariff Code	8482.10.50.68
Noun	Bearing
Keyword String	Ball
Manufacturer URL	<a href="http://www.skf.com">http://www.skf.com</a>
Manufacturer Item Number	6204-RSH
Weight / LBS	0.245
Bore	0.787 Inch   20 Millimeter
Outer Race Width	0.551 Inch   14 Millimeter
Inner Race Width	0 Inch   0 Millimeter



## KRS Guide Wheel Bearing Co., Ltd

Outside Diameter	1.85 Inch   47 Millimeter
$d_2$	25.46 mm
$D_2$	40.59 mm
$r_{1,2}$ min.	1 mm
$d_a$ min.	25.6 mm
$d_a$ max.	26 mm
$D_a$ max.	41.4 mm
$r_a$ max.	1 mm
Basic dynamic load rating C	13.5 kN
Basic static load rating $C_0$	6.55 kN
Fatigue load limit $P_u$	0.28 kN
Calculation factor $k_r$	0.025
Calculation factor $f_0$	13
Mass bearing	0.1 kg