

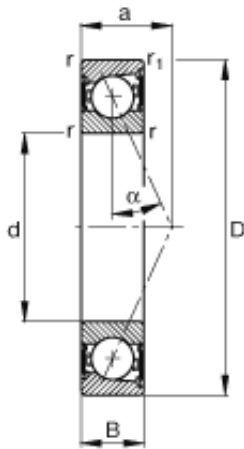

# KRS Guide Wheel Bearing Co., Ltd



## 40 mm x 62 mm x 12 mm FAG B71908-E-2RSD-T-P4S angular contact ball bearings

Bearing No. B71908-E-2RSD-T-P4S

B71908-E-2RSD-T-P4S Bearing 2D drawings and 3D CAD models

|                      |   |
|----------------------|---|
| Size                 | 40x62x12 mm   |
| Bore Diameter        | 40 mm   |
| Outer Diameter       | 62 mm   |
| Width                | 12 mm   |
| d                    | 40 mm   |
| D                    | 62 mm   |
| B                    | 12 mm   |
| a                    | 18 mm   |
| $D_a$                | 58,5 mm / Tolerance: H12                            |
| $d_a$                | 45 mm / Tolerance: h12                              |
| $r_{1 \text{ min}}$  | 0,6 mm  |
| $r_{a \text{ max}}$  | 0,6 mm  |
| $r_{a1 \text{ max}}$ | 0,6 mm  |
| $r_{\text{min}}$     | 0,6 mm  |
|                      | 25 ° / Angle  |
| m                    | 0,103 kg / Weight                                   |
| $C_r$                | 17100 N / Dynamic load rating (radial)              |
| $C_{0r}$             | 9400 N / Static load rating (radial)                |
| $n_{G \text{ Fett}}$ | 20000 1/min / Limiting speed for grease lubrication |