

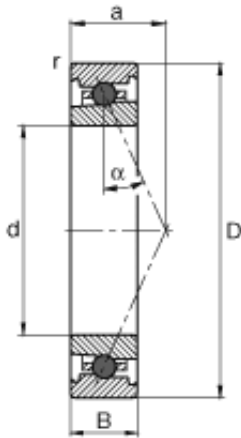

# KRS Guide Wheel Bearing Co., Ltd



## 40 mm x 62 mm x 12 mm FAG HC71908-E-T-P4S angular contact ball bearings

Bearing No. HC71908-E-T-P4S

HC71908-E-T-P4S Bearing 2D drawings and 3D CAD models

Size	40x62x12 mm
Bore Diameter	40 mm
Outer Diameter	62 mm
Width	12 mm
d	40 mm
D	62 mm
B	12 mm
a	18 mm
$D_a$	54,5 mm / Tolerance: H12
$d_a$	47 mm / Tolerance: h12
$r_{a \max}$	0,6 mm
$r_{\min}$	0,6 mm
	25 ° / Angle
m	0,119 kg / Weight
$C_r$	6400 N / Dynamic load rating (radial)
$C_{0r}$	2850 N / Static load rating (radial)
$n_{G \text{ Fett}}$	36000 1/min / Limiting speed for grease lubrication
$n_{G \text{ Ol}}$	56000 1/min / Limiting speed for minimal quantity oil lubrication