

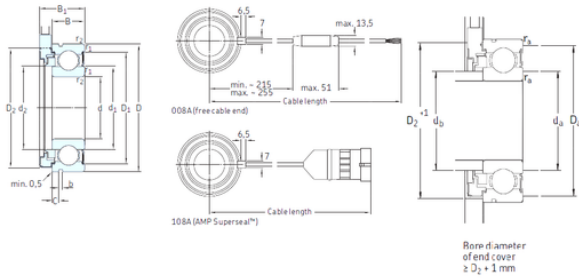

KRS Guide Wheel Bearing Co., Ltd



30 mm x 62 mm x 16 mm SKF BMO-6206/064S2/UA108A deep groove ball bearings

Bearing No. BMO-6206/064S2/UA108A

BMO-6206/064S2/UA108A Bearing 2D drawings and
3D CAD models

Size	30x62x16 mm
Bore Diameter	30 mm
Outer Diameter	62 mm
Width	16 mm
d	30 mm
D	62 mm
B	16 mm
C	16 mm
b	1,9 mm
d1	40,4 mm
d2	40,25 mm
r1 min.	1 mm
r2 min.	1 mm
B1	22,2 mm
C	3,28 mm
D1	54,1 mm
D2	58 mm
Da max.	57 mm
da. db min.	35 mm
db max.	40 mm
ra max.	1 mm
Weight	0,25 Kg
Basic dynamic load rating (C)	19,5 kN
Cable length ± 10	565



KRS Guide Wheel Bearing Co., Ltd

Phase displacement	90 ± 20 °
Basic static load rating (C0)	11,2 kN
Pulses number	64
Fatigue load limit (Pu)	0,475
Limiting speed	7500 r/min
Calculation factor (f0)	14
Category	Plain Bearings
Inventory	12.0
Manufacturer Name	SKF
Minimum Buy Quantity	N/A
UNSPSC	39121527
Weight / Kilogram	0
EAN	7316574613700
Product Group	B04264