

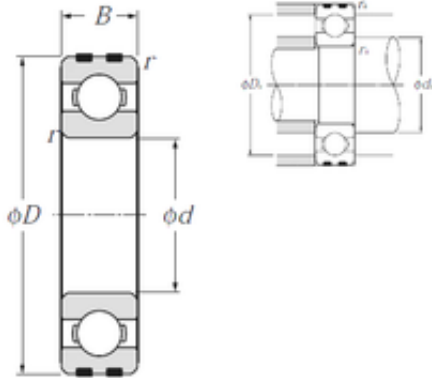

KRS Guide Wheel Bearing Co., Ltd

25 mm x 62 mm x 17 mm NTN EC-6305 deep groove ball bearings

Bearing No. EC-6305



EC-6305 Bearing 2D drawings and 3D CAD models

Size	25x62x17 mm
Bore Diameter	25 mm
Outer Diameter	62 mm
Width	17 mm
d	25 mm
D	62 mm
B	17 mm
C	17 mm
r min.	1,1 mm
da min.	31,5 mm
da max	35 mm
Da max.	55,5 mm
ra max.	1 mm
Weight	0,223 Kg
Basic dynamic load rating (C)	21,2 kN
Basic static load rating (C0)	10,9 kN
(Grease) Lubrication Speed	12 000 r/min
(Oil) Lubrication Speed	14 000 r/min