

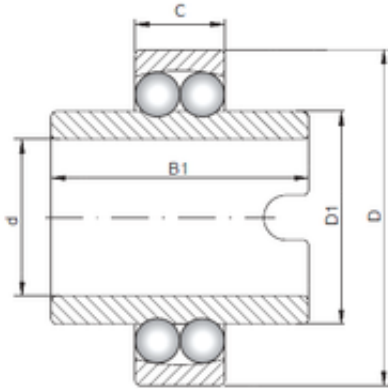

KRS Guide Wheel Bearing Co., Ltd

Loyal 11205 self aligning ball bearings



Bearing No. 11205

Size	25x52x15 mm
Bore Diameter	25 mm
Outer Diameter	52 mm
Width	15 mm
d	25 mm
D	52 mm
B1	44 mm
C	15 mm
D1	33,3 mm
Weight	0,22 Kg
Basic dynamic load rating (C)	14,3 kN
Basic static load rating (C0)	4 kN

11205 Bearing 2D drawings and 3D CAD models