

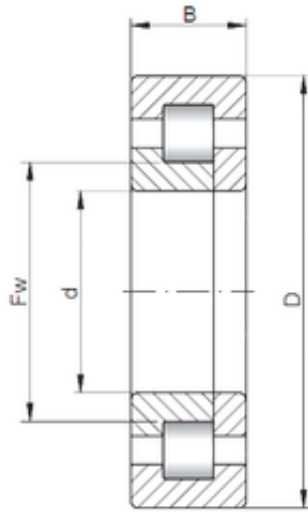

# KRS Guide Wheel Bearing Co., Ltd



110 mm x 170 mm x 28 mm ISO NUP1022  
cylindrical roller bearings

Bearing No. NUP1022

Size	110x170x28 mm
Bore Diameter	110 mm
Outer Diameter	170 mm
Width	28 mm
d	110 mm
D	170 mm
B	28 mm
C	28 mm

NUP1022 Bearing 2D drawings and 3D CAD models